

**MICROPlumb®
PRODUCTS
24 VAC/100 VA
Plug-In Transformer**

**MCR
427**



► **Description**

Class 2, Step-Down Transformer

► **Rating**

- Output: 100 VA
- Primary: 120 VAC @ 50/60 Hz
- Secondary: 24 VAC

► **Specifications**

- 3-Conductor X 16 GA., 6 foot long power cord
- 3-Prong plug
- Foot mounting

► **Usage**

Recommended for use on multi-combination units or more than three lavatory/shower solenoid valves.

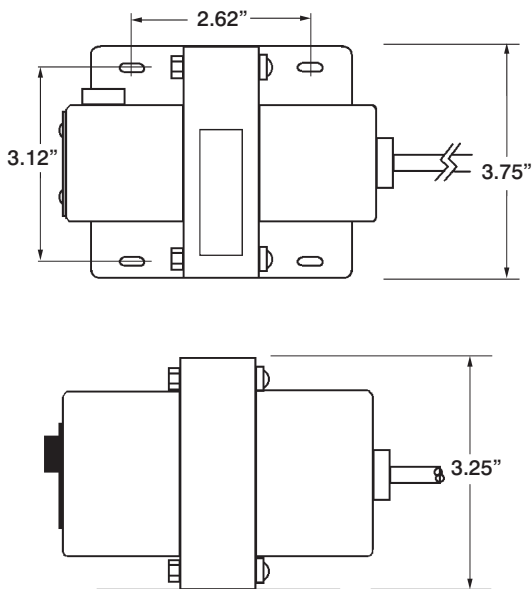

This space for Architect/Engineer approval

The information contained in this document is subject to change without notice.

FWI® **PROGRAMMED WATER
TECHNOLOGIES**
A SLOAN VALVE COMPANY